

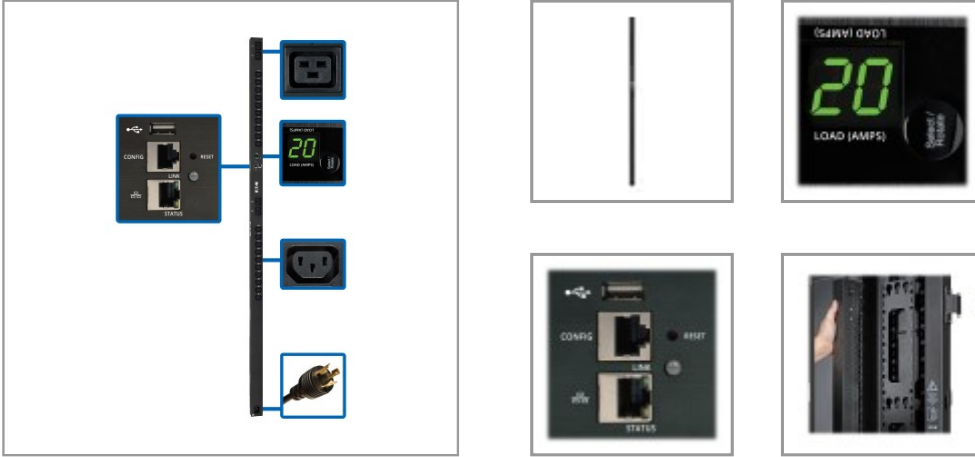

Powering Business Worldwide

## 3.7kW Single-Phase Switched PDU - LX Interface, 208/230V Outlets (20 C13 & 4 C19), C20/L6-20P, 0U, TAA

MODEL NUMBER: PDUMV20HVNETLX



3.7kW vertical PDU distributes, monitors and manages single-phase power in an IT or industrial environment. Built-in network interface helps you remotely monitor load levels to prevent overloads that cause downtime.

### Description

The PDUMV20HVNETLX 3.3-3.7kW Single-Phase Switched PDU provides advanced network control and remote power monitoring with the ability to turn on, turn off, reboot or lock out power to each outlet. Recommended for any IT or industrial application, it features 24 switched outlets (20 C13 and 4 C19) with included plug-lock insert sleeves to prevent cables from becoming accidentally disconnected. A 10-ft. (3.05 m) cord with NEMA L6-20P plug connects the PDU's C20 inlet to a compatible AC power source, generator or protected UPS.

The built-in Java-free HTML5-based LX Platform network interface enables full remote access for PDU status monitoring and email notifications via secure web browser, SNMP, telnet or SSH. It supports 10/100 Mbps auto-sensing for optimum communication with an Ethernet network. Optional EnviroSense2 modules (sold separately) provide a variety of environmental monitoring capabilities. Protocols supported include HTTP, HTTPS, SMTP, SNMPv1, SNMPv2, SNMPv3, telnet, SSH, FTP, DHCP and NTP.

A digital ammeter allows you to monitor each bank's load in real time to ensure it remains well below maximum capacity with no danger of overload. The vertical PDU mounts in 0U of space in EIA-standard 19-inch racks using the included toolless mounting buttons or the included rack-mounting brackets. Use the included PDUMVROTATEBRKT kit to install the unit with outlets facing the rear for better airflow or equipment access.

### Features

**Distributes Network-Grade Single-Phase Power** 3.3-3.7kW 208/230V switched rack PDU (rPDU) Recommended for network applications requiring individual outlet control, load shedding and remote monitoring of critical network components Includes detachable NEMA L6-20P plug with 10-ft. (3.05 m) cord; C20 inlet supports user-supplied international input cabling Firmware upgrades support future product enhancements

**24 Switched Outlets Distribute AC Power** 20 C13 and 4 C19 outlets split into 2 separately breakered load banks Individual outlets can be remotely controlled to power up, power down, reboot or lock out devices Plug-lock inserts prevent cables from becoming accidentally disconnected

**Digital Ammeter** Reports load level on each bank and total PDU output Supports IP-address self-ID Rotates 180° for easy reading at either angle

**Built-In LX Platform Interface** Pre-installed WEBCARDLX with the latest version of PowerAlert Device

### Highlights

- 3.3/3.7kW 208/230V switched PDU
- 24 individually controllable outlets—20 C13, 4 C19
- Pre-installed WEBCARDLX with latest version of PADM20 for IP-based Auto Probe feature
- Digital ammeter for on-site load monitoring in real time
- C20 inlet with 10ft NEMA L6-20P AC power cord

### Package Includes

- PDUMV20HVNETLX 3.3-3.7kW Single-Phase Switched PDU
- Built-in LX Platform interface
- Detachable NEMA L6-20P to C19 power cord, 10-ft. (3.05 m)
- Configuration cable
- (24) Plug-lock inserts
- Rack-mounting hardware
- PDUMVROTATEBRKT mounting bracket accessory
- Owner's manual



Powering Business Worldwide

Manager firmware (PADM20) provides enhanced remote management capabilities. PADM20 and PowerAlert Element Manager (PAEM) form a powerful tool for expanding maintenance functions in large installations, including firmware update checks and backup and restoration of device configurations. IP-based Auto Probe detects lost connectivity and restores service autonomously.

**Easy 0U Installation in EIA-Standard 19 in. Racks** Mounts vertically using included toolless buttons or rack-mounting brackets. Included PDUMVROTATEBRKT allows mounting with rear-facing outlets.

**TAA-Compliant** Compliant with the Federal Trade Agreements Act (TAA) for GSA Schedule purchases.

## Specifications

OVERVIEW	
UPC Code	037332205292
PDU Type	Switched
INPUT	
Input Phase	Single-Phase
PDU Input Voltage	208; 230
Recommended Electrical Service	Single-phase 16/20A 230/208V service
Maximum Input Amps	16
Maximum Input Amps Details	Agency de-rated to 16A continuous
Input Connection Type	C20 inlet accepts included L6-20P input cable
PDU Plug Type	NEMA L6-20P; IEC-320 C20
Input Cord Length (ft.)	10
Input Cord Length (m)	3.05
OUTPUT	
Output Capacity Details	3.68kW (230V), 3.33kW (208V) / 16A total capacity; 16A max per C19 outlet; 12A (10A CE) max per C13 outlet
Frequency Compatibility	50 / 60 Hz
Output Receptacles	(20) C13; (4) C19
Output Nominal Voltage	208/230V
Customized Load Management Receptacles	Each outlet is individually controllable via remote interface
USER INTERFACE, ALERTS & CONTROLS	
Front Panel LCD Display	Digital meter reports PDU output current in amps
Front Panel LEDs	24 power availability LEDs confirm power off/on status for each built-in outlet; LX Platform Interface status LED (Green); Network Link/Activity LED (Yellow), Network Speed LED (Green)
Switches	Push button to rotate digital display and view IP address. LX Platform Interface: Recessed reset switch for interface reboot and factory reset
SURGE / NOISE SUPPRESSION	



Powering Business Worldwide

Automatic Shut-Off	No
<b>PHYSICAL</b>	
Material of Construction	Metal
Rack Height	0U
Form Factors Supported	0U vertical rackmount; includes rackmount brackets. Supports toolless mounting in button-mount compatible racks
PDU Form Factor	Vertical (0U)
Shipping Dimensions (hwd / in.)	5.30 x 6.40 x 73.00
Shipping Dimensions (hwd / cm)	13.46 x 16.26 x 185.42
Shipping Weight (lbs.)	14.20
Shipping Weight (kg)	6.44
Unit Dimensions (hwd / in.)	70.000 x 2.190 x 2.650
Unit Dimensions (hwd / cm)	177,8 x 5,6 x 6,7
Unit Weight (lbs.)	8.5
Unit Weight (kg)	3.86
<b>ENVIRONMENTAL</b>	
Operating Temperature Range	32° to 104°F (0° to 40°C)
Storage Temperature Range	-22° to 140°F (-30° to 60°C)
Relative Humidity	5% to 95% non-condensing
Operating Elevation	0-10000 ft. (0-3000 m)
<b>COMMUNICATIONS</b>	
PowerAlert Software	LX Platform Interface: PowerAlert Device Manager
Communications Cable	RJ45-to-DB9 configuration/console Access cable
Network Monitoring Port	RJ45 Network port; RJ45 Config/Console Access port; USB A port supports a variety of Envirosense2 environmental and control modules. See Accessories>Management Hardware section for more information about these modules.
SNMP Compatibility	Pre-installed LX platform interface provides remote monitoring via Java-free HTML5 web interface, telnet, SSH and SNMP management systems
Network Compatibility	10 Mbps; 100 Mbps (Fast Ethernet)
<b>FEATURES &amp; SPECIFICATIONS</b>	
High Availability PDU Features	Auto Probe Monitoring and Reboot (included); Auto Load Shedding
<b>STANDARDS &amp; COMPLIANCE</b>	
Product Certifications	EN 55022; EN 55024; CAN/CSA-C22.2 No. 60950-1 (Canada); IEC 60950-1; NOM (Mexico); UL 60950-1
Product Compliance	RoHS; FCC Part 15 Class A (USA); Trade Agreements Act (TAA)
<b>WARRANTY &amp; SUPPORT</b>	



*Powering Business Worldwide*

Product Warranty Period (Worldwide)	2-year limited warranty
--	-------------------------

1000 Eaton Boulevard  
Cleveland, OH 44122  
United States  
<https://tripplite.eaton.com>

© 2024 Eaton. All Rights Reserved.  
Eaton is a registered trademark. All other trademarks  
are the property of their respective owners.