

**PRODUCT CODE: CS29-GA**  
CHANNEL SPRING NUT



**DESCRIPTION**

M8 Long Spring Nut

**FINISH**

Hot Dipped Galvanised

**MATERIAL**

Steel

**PACKAGING**

Packed in qty 100

**ADDITIONAL NOTES**

Produced to comply with the requirements of BS6946 Metal Channel Support Systems  
For use with 41mm depth channel  
Compliant to LU Standard 1-085 (for use on surface & sub-surface locations)

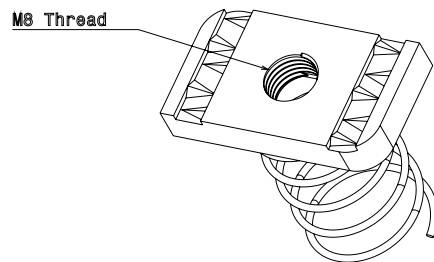

Isometric view

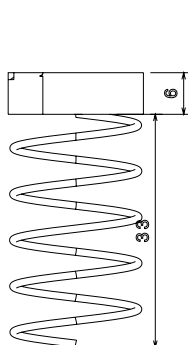

Front view

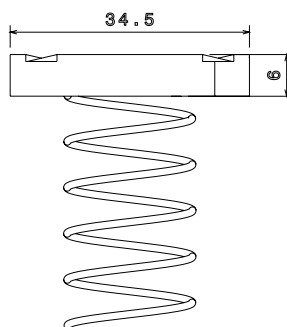

Side view

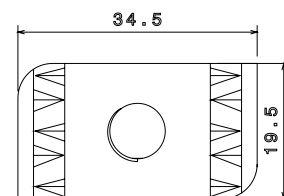

Top view